

NOTE: ANY APPLICATIONS INVOLVING BUILDING NEAR TO AN EXISTING FOUL AND/OR STORM SEWER THAT IS LOCATED LESS THAN 500mm FROM THE EXISTING SEWERS WILL BE REFUSED AND IT IS RECOMMENDED THAT PRIOR DISCUSSION WITH THE APPROPRIATE NI WATER STAFF OCCURS.

NEW FOUNDATIONS (ADJACENT EDGE) OF THE PROPOSED EXTENSION GREATER THAN 500mm FROM THE EXISTING SEWER PIPELINES (SUBJECT TO THE DEPTH OF THE PIPELINE TO BE BUILT NEAR TO) ARE TO BE TAKEN DOWN TO A SUITABLE SUBSOIL BEARING STRATA AT LEAST 150mm BELOW THE INVERT LEVEL OF THE PIPELINE TO BE BUILT NEAR TO.

WHERE CONNECTIONS ARE TO BE MADE TO AN EXISTING FOUL SEWER A NEW 1200MMØ PC RING WITH A 675MM X 675MM MEDIUM DUTY CAST IRON LID IS TO BE INSTALLED. IF THE EXISTING PIPE WHERE THE MANHOLE IS TO BE FORMED IS CLAY THEN THE PIPE THROUGH THE MANHOLE AND FOR A DISTANCE OF 300mm UPSTREAM AND DOWNSTREAM OF THE MANHOLE IS TO BE REPLACED WITH A UPVC FOUL SEWER (COLOURED RED). INDICATIVE DEPTH OF THE ***MMØ PIPE = *.**M

WHERE CONNECTIONS ARE TO BE MADE TO AN EXISTING STORM SEWER A NEW 1200MMØ PC RING WITH A 675MM X 675MM MEDIUM DUTY CAST IRON LID IS TO BE INSTALLED. IF THE EXISTING PIPE WHERE THE MANHOLE IS TO BE FORMED IS CLAY THEN THE PIPE THROUGH THE MANHOLE AND FOR A DISTANCE OF 300mm UPSTREAM AND DOWNSTREAM OF THE MANHOLE IS TO BE REPLACED WITH A UPVC STORM SEWER (COLOURED GREEN). INDICATIVE DEPTH OF THE ***MMØ PIPE = *.**M

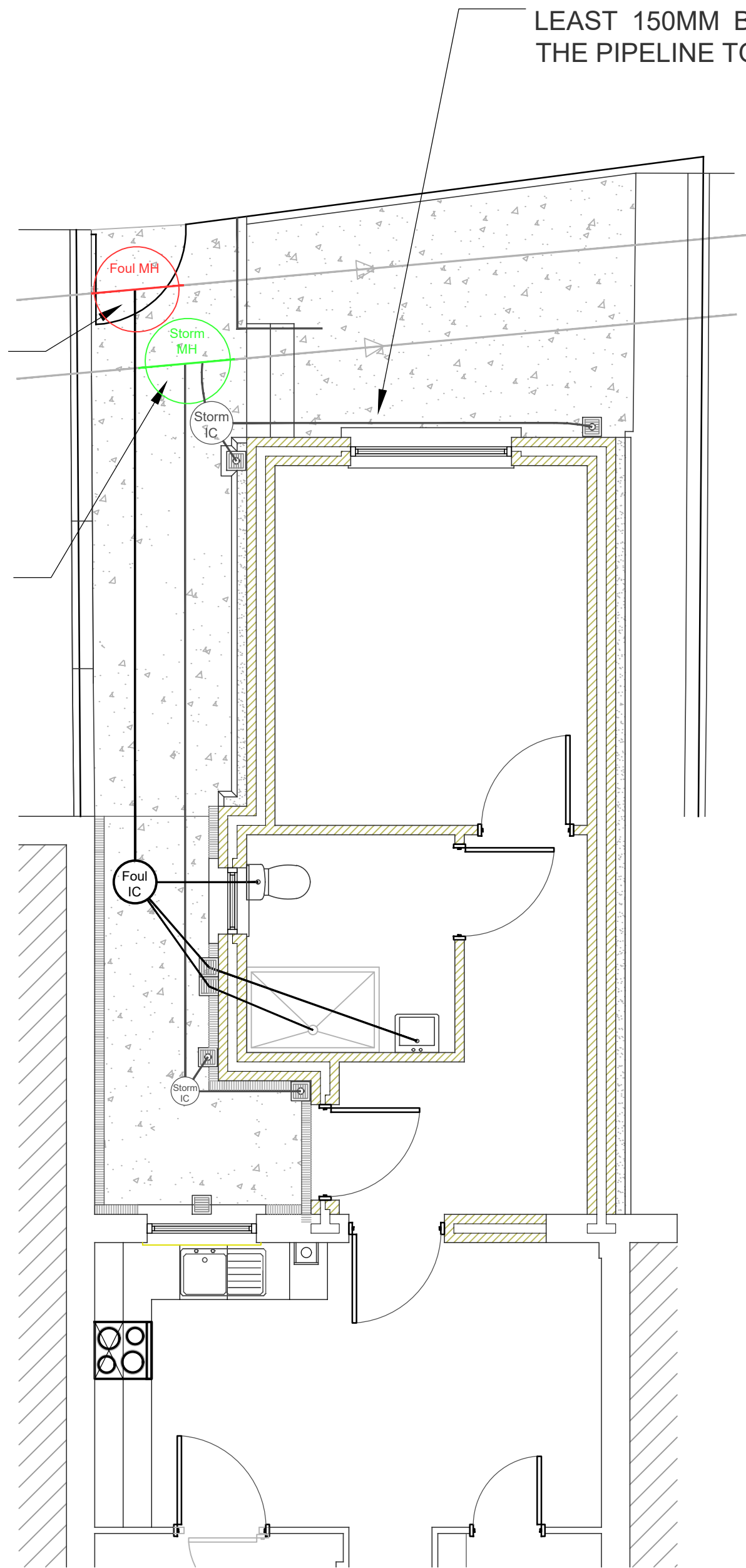

TYPICAL BUILD 'NEAR TO' PROPOSED SITE PLAN
SCALE: 1:50

STORM DRAINAGE SYSTEM (COLOURED GREEN): BETWEEN 300mm UPSTREAM OF THE NEW STORM MANHOLE TO 300mm DOWNSTREAM THE EXISTING ***MMØ CLAY PIPE BETWEEN THESE POINTS IS TO BE REPLACED WITH A ***MMØ UPVC PIPE FITTED WITH ADAPTORS / FLEXIBLE COUPLERS AT EITHER END TO CONNECT THE NEW UPVC PIPE TO THE EXISTING CLAY PIPE.

FOUL DRAINAGE SYSTEM (COLOURED RED): BETWEEN 300mm UPSTREAM OF THE NEW FOUL MANHOLE TO 300mm DOWNSTREAM THE EXISTING ***MMØ CLAY PIPE BETWEEN THESE POINTS IS TO BE REPLACED WITH A ***MMØ UPVC PIPE FITTED WITH ADAPTORS / FLEXIBLE COUPLERS AT EITHER END TO CONNECT THE NEW UPVC PIPE TO THE EXISTING CLAY PIPE.

MANHOLE DETAILS: ALL MANHOLES TO BE CONSTRUCTED TO THE CURRENT NI WATER SPECIFICATION I.E. 1200MMØ PC RINGS FITTED WITH A 675MM X 675MM MEDIUM DUTY (MINIMUM ACCEPTABLE) CAST IRON LID.

450MMØ PREFORMED UPVC BASES AND INSPECTION CHAMBERS ARE STRICTLY FORBIDDEN TO BE USED ON ANY NI WATER INFRASTRUCTURE.

EXISTING DRAINAGE: GIVEN THAT THE EXISTING DRAINAGE MUST BE MAINTAINED THE PROPOSED CONTRACTOR IS TO ENSURE THAT NO DAMAGE (INCLUDING EXISTING MANHOLE COVER LIDS) OR BLOCKAGES OCCUR DURING THE CONSTRUCTION WORKS TO THE EXISTING FOUL AND STORM SEWERS. ANY DAMAGES WILL REQUIRE REPLACEMENT IN COMPLIANCE WITH NI WATER STANDARDS.

